

SPOTLIGHT

TRACK or CEILING

IRIS

---



*A track mounted luminaire with four different light sources. It highlights impressively premises, such as shopping malls, stores, hotels, exhibition halls, museums etc. It is compact and efficient and it has high-precision light distribution.*

#### Technical Features

---

- Aluminium body, painted electrostatically in selected colour.
- High pure aluminium reflectors in Spot, Medium, Wide versions.
- Tempered protection glass.
- With Universal adapter for mounting on 3-phase track.
- Connection for operation on 230V-50/60Hz with electronic ballast.

#### Upon request

- Connection for operation with electronic dimmable ballast.

**IRIS**

**IRIS - HIT-CE / HIT-TC-CE / QR111 / HI-PAR111 / LED R111**



- Version for HIT-CE/G12, HIT-TC-CE/G8,5, QR111/G53, HI-PAR111/GX8,5, LED R111/GU10.
- Aluminium body.
- High pure aluminium reflectors in Spot, Medium, Wide versions and tempered protection glass for HIT-CE and HIT-TC-CE versions.
- With Universal adapter for mounting on 3-phase track.

Code	Description	Kg
89431	IRIS 35W HIT-CE / G12 SPOT	1,050
89441	IRIS 35W HIT-CE / G12 MEDIUM	1,050
89451	IRIS 35W HIT-CE / G12 WIDE	1,050
89432	IRIS 70W HIT-CE / G12 SPOT	1,050
89442	IRIS 70W HIT-CE / G12 MEDIUM	1,050
89452	IRIS 70W HIT-CE / G12 WIDE	1,050
89435	IRIS 35W HIT-TC-CE / G8,5 SPOT	1,050
89445	IRIS 35W HIT-TC-CE / G8,5 MEDIUM	1,050
89455	IRIS 35W HIT-TC-CE / G8,5 WIDE	1,050
89436	IRIS 70W HIT-TC-CE / G8,5 SPOT	1,050
89446	IRIS 70W HIT-TC-CE / G8,5 MEDIUM	1,050
89456	IRIS 70W HIT-TC-CE / G8,5 WIDE	1,050
89467	IRIS 35W HI-PAR 111 / GX8,5	1,000
89468	IRIS 70W HI-PAR 111 / GX8,5	1,000
89469	IRIS QR111/G53 max. 60W	1,000
89460	IRIS LED R111 / GU10	1,100

CE	F	IP 20
170°	350°	

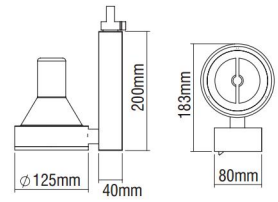

**IRIS - LEVEL HIT-CE / HIT-TC-CE / QR111 / HI-PAR111 / LED R111**



- Version for HIT-CE/G12, HIT-TC-CE/G8,5, QR111/G53, HI-PAR111/GX8,5, LED R111/GU10.
- Aluminium body.
- High pure aluminium reflectors in Spot, Medium, Wide versions and tempered protection glass for HIT-CE and HIT-TC-CE versions.
- With Universal adapter for mounting on 3-phase track.

Code	Description	Kg
89861	IRIS LEVEL 35W HIT-CE / G12 SPOT	1,050
89871	IRIS LEVEL 35W HIT-CE / G12 MEDIUM	1,050
89881	IRIS LEVEL 35W HIT-CE / G12 WIDE	1,050
89862	IRIS LEVEL 70W HIT-CE / G12 SPOT	1,050
89872	IRIS LEVEL 70W HIT-CE / G12 MEDIUM	1,050
89882	IRIS LEVEL 70W HIT-CE / G12 WIDE	1,050
89865	IRIS LEVEL 35W HIT-TC-CE / G8,5 SPOT	1,050
89875	IRIS LEVEL 35W HIT-TC-CE / G8,5 MEDIUM	1,050
89885	IRIS LEVEL 35W HIT-TC-CE / G8,5 WIDE	1,050
89866	IRIS LEVEL 70W HIT-TC-CE / G8,5 SPOT	1,050
89876	IRIS LEVEL 70W HIT-TC-CE / G8,5 MEDIUM	1,050
89886	IRIS LEVEL 70W HIT-TC-CE / G8,5 WIDE	1,050
89867	IRIS LEVEL 35W HI-PAR 111 / GX8,5	1,000
89868	IRIS LEVEL 70W HI-PAR 111 / GX8,5	1,000
89869	IRIS LEVEL QR111/G53 max. 60W	1,000
89860	IRIS LEVEL LED R111 / GU10	1,100

CE	F	IP 20
170°	350°	

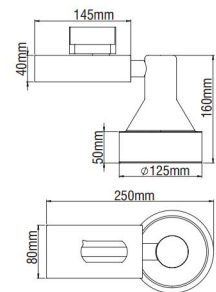

**Colour Codes:**

0	Colours	1	White	2	Titan	3	Black	4	Chrome
---	---------	---	-------	---	-------	---	-------	---	--------